

8 SPEED 4WD (Full Electronic Control)



AUTOMATIC CHOICE



THE AUTOMATIC TRANSMISSION PARTS WAREHOUSE

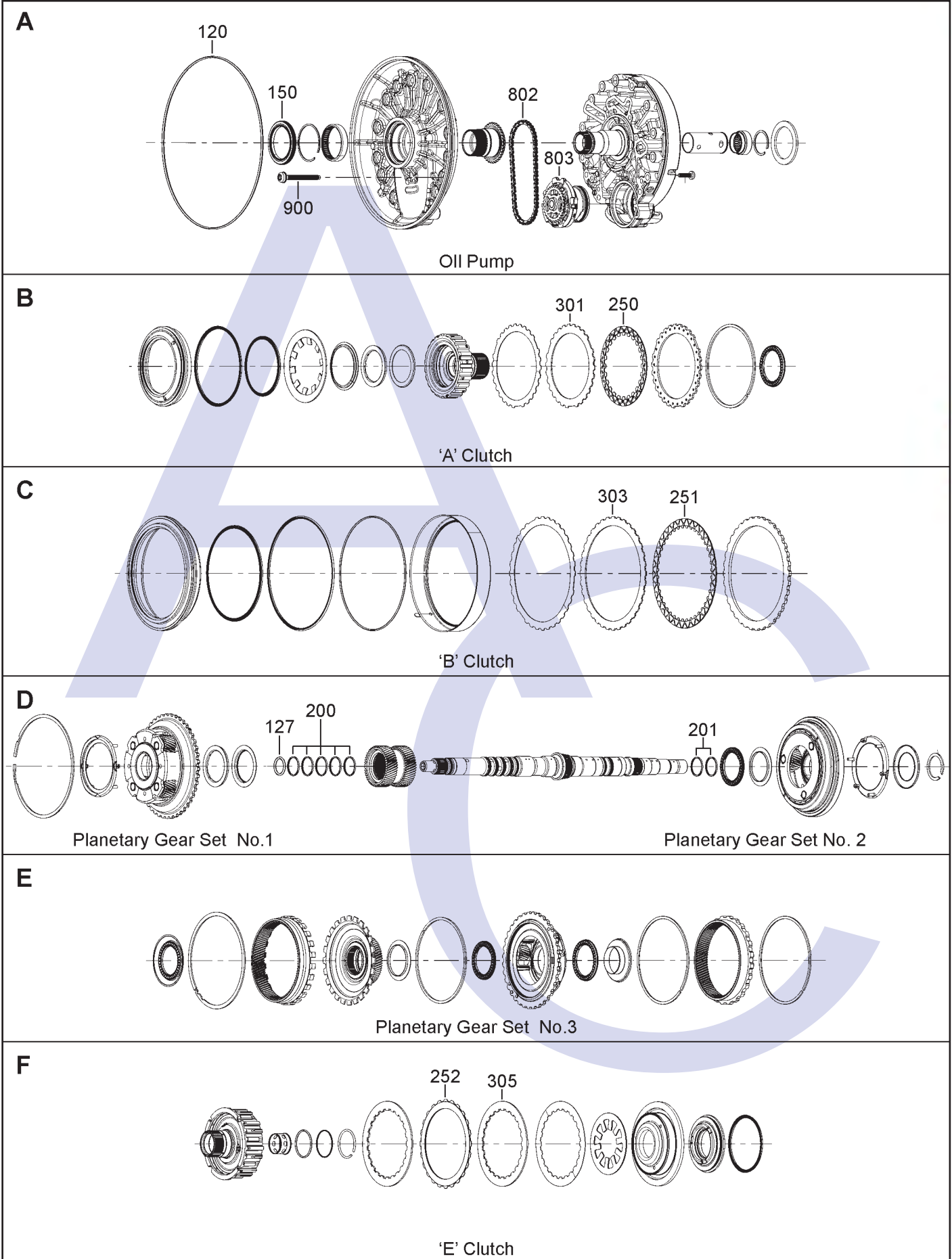

8 SPEED 4WD (Full Electronic Control)



AUTOMATIC CHOICE



THE AUTOMATIC TRANSMISSION PARTS WAREHOUSE

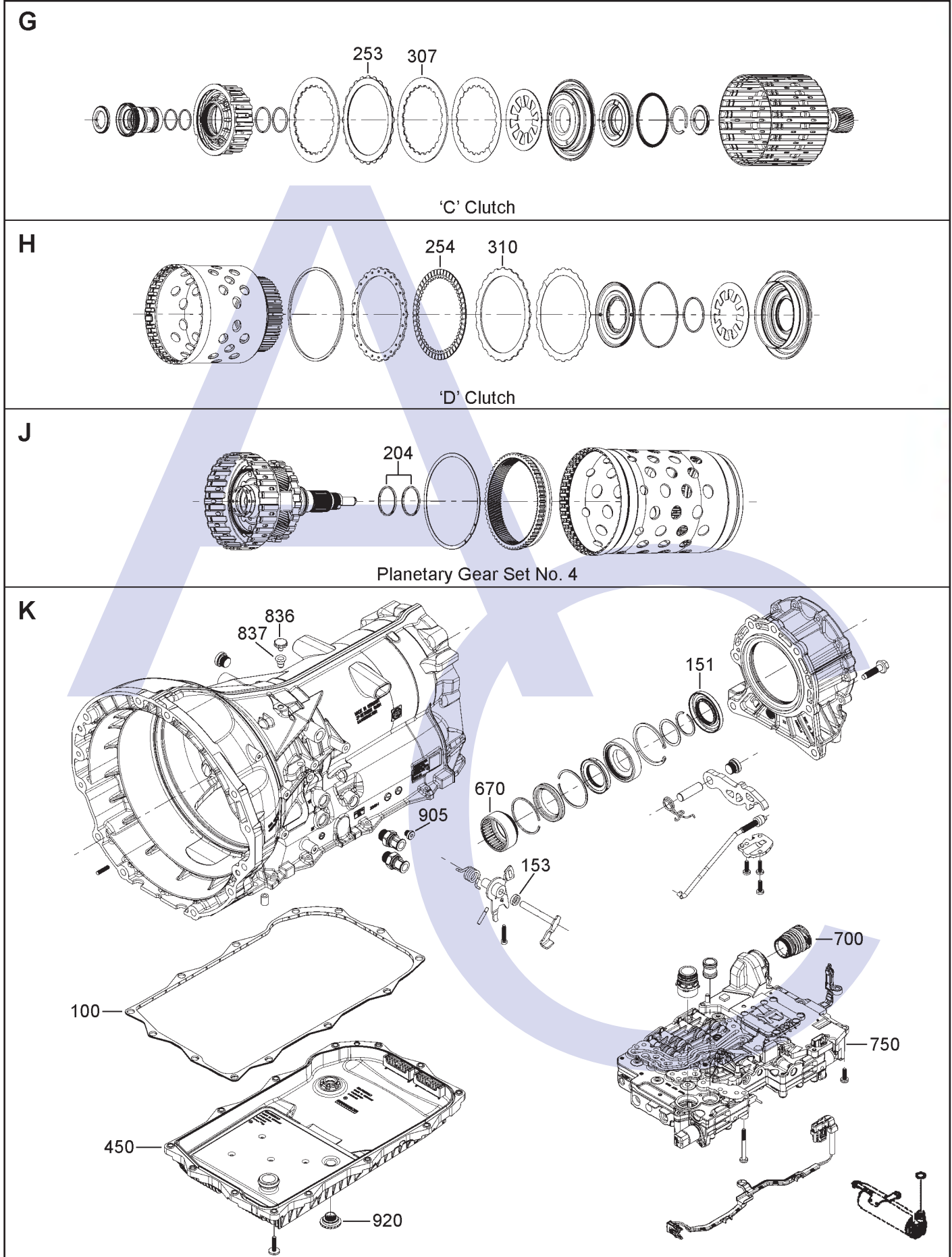

8 SPEED 4WD (Full Electronic Control)



AUTOMATIC CHOICE

ILL NO.	DESCRIPTION	YEARS	QTY	PART NO
KITS				
Kit	Overhaul Kit 8HP45/845RE (Transtec).....	11-ON	1	8HP45.OHK02
GASKETS				
100K	Pan Gasket, Rubber (OE).....	11-ON	1	8HP45.GAS01
100K	Pan Gasket, Rubber (Transtec®).....	11-ON	1	8HP45.GAS11
RUBBER COMPONENTS				
120A	'O' Ring, Front Cover to Case ...	11-ON	1	8HP45.OR01
127D	'O' Ring, Input Shaft Lock Up....	11-ON	1	8HP45.OR02
METAL CLAD SEALS				
150A	Converter to Centring Plate (OE)	11-ON	1	8HP45.MCS01
150A	Converter to Centring Plate (Transtec®).....	11-ON	1	8HP45.MCS11
151K	Output Seal	11-ON	1	8HP45.MCS13
153K	Manual Shaft Seal (Transtec®).....	11-ON	1	8HP70.MCS04
MOULDED PISTONS				
Kit	Bonded Piston.....	11-ON	1	8HP45.PISKIT01
SEALING RINGS				
Kit	Sealing Ring (Transtec®).....	11-ON	1	8HP45.SRK01
200D	Input Shaft Front (Transtec®) ...	11-ON	5	8HP45.SSR01
201D	Input Shaft Rear (Transtec®)....	11-ON	2	8HP45.SSR01
204J	Output Shaft to 'D' Clutch (Transtec®).....	11-ON	2	8HP45.SSR02
FRICTION PLATES				
Kit	Friction Plate (AM)	11-ON	1	8HP45.FRK03
Kit	Friction Plate (Allomatic) (26 Frictions).....	11-ON	1	8HP45.FRK11
250B	'A' Clutch (OEM)	11-ON	5	8HP45.FRP01
250B	'A' Clutch (AM)	11-ON	5	8HP45.FRP51
251C	'B' Clutch (OEM)	11-ON	5	8HP45.FRP02
251C	'B' Clutch (AM)	11-ON	5	8HP45.FRP52
252F	'E' Clutch, Outer Spline (OEM) .	11-ON	6	8HP45.FRP03
252F	'E' Clutch, Outer Spline (AM)	11-ON	6	8HP45.FRP53
253G	'C' Clutch, Outer Spline (OEM) .	11-ON	6	8HP45.FRP03
253G	'C' Clutch, Outer Spline (AM)....	11-ON	6	8HP45.FRP53
254H	'D' Clutch, Waved (OEM)	11-ON	4	8HP45.FRP04
254H	'D' Clutch, Waved (AM).....	11-ON	4	8HP45.FRP54
STEEL PLATES				
Kit	Steel Plate (AM).....	11-ON	1	8HP45.STK03
Kit	Steel Plate (Allomatic) (26 Steel Plates)	11-ON	1	8HP45.STK11
301B	'A' Clutch (OEM)	11-ON	5	8HP45.STP01
301B	'A' Clutch (AM)	11-ON	5	8HP45.STP51
303C	'B' Clutch (OEM)	11-ON	5	8HP45.STP02
303C	'B' Clutch (AM)	11-ON	5	8HP45.STP52

ILL NO.	DESCRIPTION	YEARS	QTY	PART NO
STEEL PLATES Con...				
305F	'E' Clutch (OEM)	11-ON	6	8HP45.STP03
305F	'E' Clutch (AM)	11-ON	6	8HP45.STP53
307G	'C' Clutch (OEM)	11-ON	6	8HP45.STP03
307G	'C' Clutch (AM)	11-ON	6	8HP45.STP53
310H	'D' Clutch (OEM)	11-ON	4	8HP45.STP04
310H	'D' Clutch (AM)	11-ON	4	8HP45.STP54
PRESSURE PLATES				
SPRINGS & CIRCLIPS				
FILTERS				
450K	Oil Pan Kit (Kit Contains Sump Pan, Bolts, Sump Plug, Filter and 7 Litres of Oil).....	11-ON	1	8HP45.PAN01
450K	Oil Pan and Filter Kit W/ Bolts (OEM, No Oil)	11-ON	1	8HP70.PAN01
450K	Oil Pan and Filter Kit W/ Bolts (Aftermarket, No Oil)	11-ON	1	8HP70.PAN11
BUSHINGS				
THRUST WASHERS & BEARINGS				
670K	Needle Bearing, Output Shaft...	11-ON	1	6HP26.BE02
ELECTRICAL COMPONENTS				
700K	Case Connector/Guide Sleeve .	11-ON	1	8HP45.ELE01
VALVE BODY PARTS				
750K	Mechatronic Unit (Exchange) (Box Code & Vehicle Details Required)	11-ON	1	8HP45.VBxx
HARD PARTS				
802A	Drive Chain, Oil Pump	11-ON	1	8HP45.CH01
803A	Oil Pump	11-ON	1	8HP45.PUM01
836K	Plastic Breather Cap	11-ON	1	5HP19.CAP01
837K	Plastic Breather Tube.....	11-ON	1	5HP19.BRE01



THE AUTOMATIC TRANSMISSION PARTS WAREHOUSE

8 SPEED 4WD (Full Electronic Control)



AUTOMATIC CHOICE

ILL NO.	DESCRIPTION	YEARS	QTY	PART NO
SPECIAL ITEMS				
900A	Bolt, Pump to Case (Aluminium) .	11-ON	13	8HP45.NUT01
905K	Screw Plug, Casing (M10x1)	11-ON	1	4HP20.PLU01
920K	Plug, Oil Pan (Plastic).....	11-ON	1	8HP45.PLU01
920K	Plug, Oil Pan 8HP45X (M10x1) (Codes 1090 020 021, 043)	11-ON	1	4HP20.PLU01
NI	LifeGuardFluid8 Transmission Fluid (1 x 1 Ltr Bottle)	11-ON	AR	OIL.67
	(1 x 10 Ltr Canister)	11-ON	AR	OIL.77
	(1 x 20 Ltr Canister)	11-ON	AR	OIL.68
	(1 x 209 Ltr Barrel).....	11-ON	AR	OIL.65
TOOLS & MANUALS				

ILL NO.	DESCRIPTION	YEARS	QTY	PART NO
---------	-------------	-------	-----	---------



THE AUTOMATIC TRANSMISSION PARTS WAREHOUSE